



PROJECT GOALS

- Strengthen the relationship between living and learning on the UC San Diego campus
- Provide Residential, Academic and Community facilities to address increased enrollment demand
- Create a new home for Thurgood Marshall College that honors and reflects its legacy and values within the larger university context
- Redevelop end of life 250 bed residential site with 2,400 beds, while strengthening connections to the university center, Ridge Walk, and campus open spaces
- Advance educational initiatives by providing general assignment classrooms (approximately 960 seats)
- Replace outdated facilities and provide a new consolidated facility for the Economics Department and elements of the School of Global Policy and Strategy
- Exemplify campus sustainability initiatives and obtain LEED Gold certification or better

BUILDING A
18 LEVELS

15 LEVELS

BUILDING B
16 LEVELS

12 LEVELS

BUILDING C
10 LEVELS

**ECONOMICS
GLOBAL POLICY & STRATEGY**
6 LEVELS

ACADEMIC
3 LEVELS

RIDGE WALK

VIEW LOOKING EAST

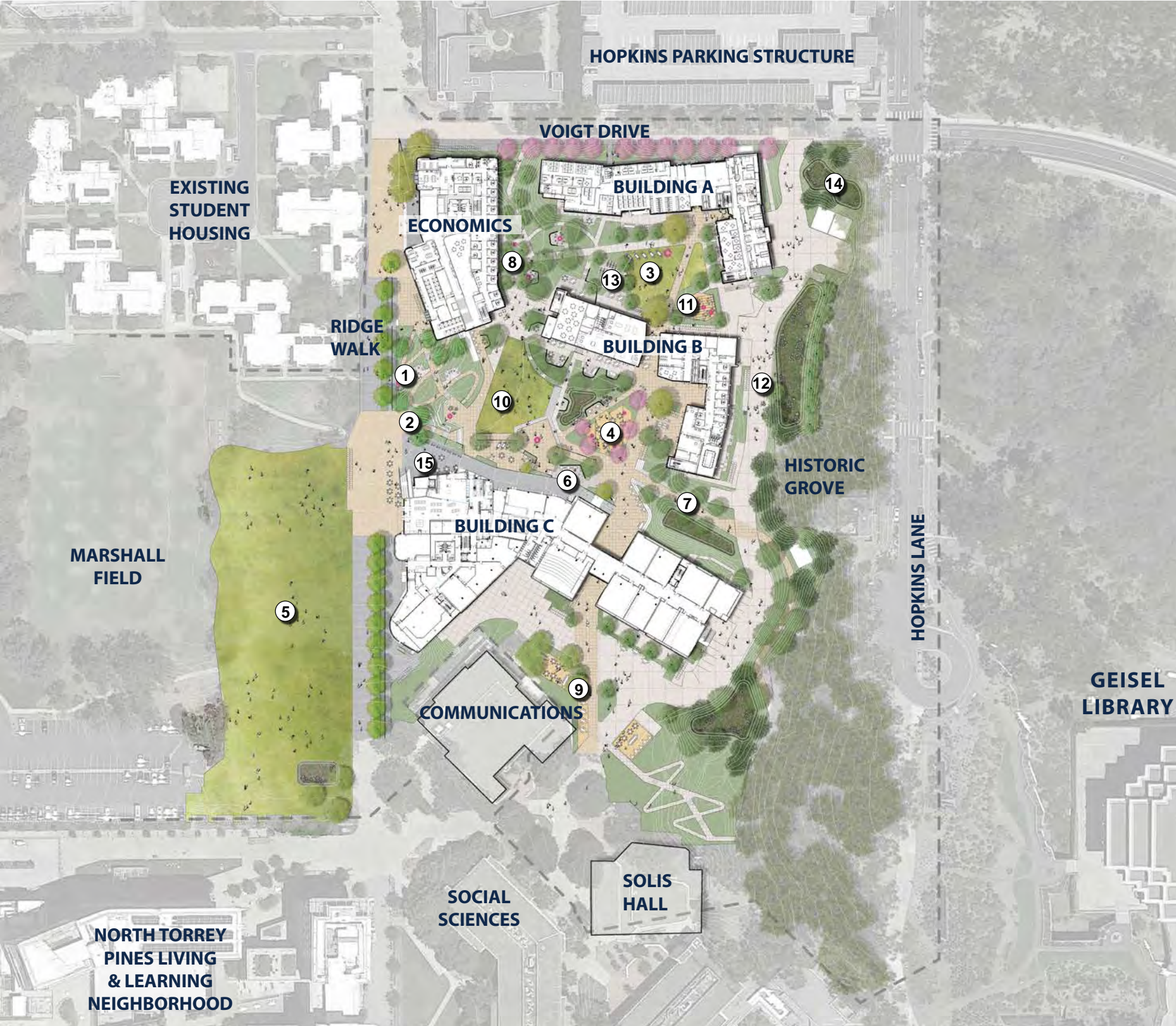

- ① THE KUMEYAAY GARDEN
- ② MARSHALL STEPS
- ③ THE QUOTEYARD
- ④ THE HUDDLE
- ⑤ ACTIVITY GREEN
- ⑥ COALITION COURT
- ⑦ THE GLEN
- ⑧ ART WALK
- ⑨ SOLIS GARDEN
- ⑩ GAVEL GREEN
- ⑪ OUTDOOR LOUNGE
- ⑫ GROVE PROMENADE
- ⑬ TMC COMMUNITY GARDEN
- ⑭ BIORETENTION BASINS
- ⑮ MARKET / CAFE OUTDOOR SEATING

USE SUMMARY:
BUILDING A: RESIDENTIAL
BUILDING B: RESIDENTIAL
BUILDING C: MIXED USE
 ACADEMIC/RESIDENTIAL
ECONOMICS: ACADEMIC

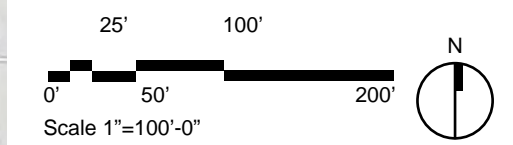



View of the Kumeyaay Garden Looking North



View from Ridge Walk Toward Geisel Library



① Building B Game Room



② Economics Building Basic Needs Kitchen



③ Building C Thurgood Marshall College Lobby at 2nd Floor



① Economics Building Open-Air Atrium



② View from Housing Nook Space



③ Two-Story Great Room



Ten-Bed Suite Organization



Eight-Bed Suite Organization



Living Room Elevation

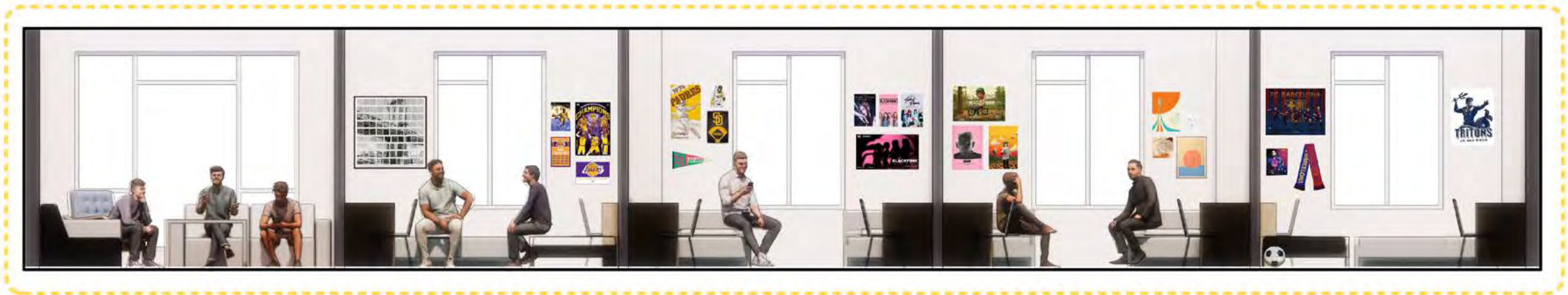

Eight-Bed Suite Bedroom Elevation

MATERIALS

The colors and textures of the Historic Grove are the inspiration behind the earthy palette, which expands into a broader range of rich, natural hues.

The incorporation of natural and tactile materials (such as wood, natural fibers, etc) into a space can also support mental well-being. The use of tactile materials encourages employees to engage directly with their sense of touch — an often overlooked aspect of well-being.

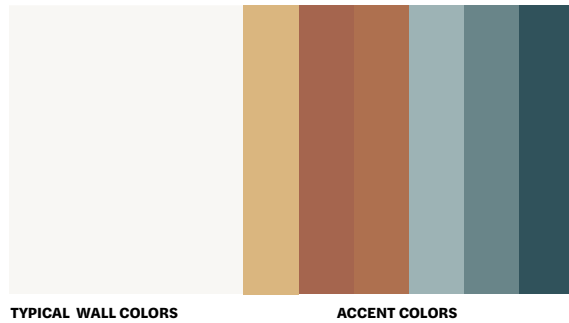

CARPET - FACULTY LOUNGE



WOOD CEILINGS AT LOBBIES & NON-PAINTED DOORS

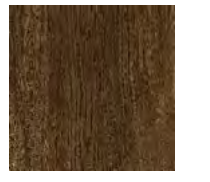

ACCENT WOOD AT HOUSING

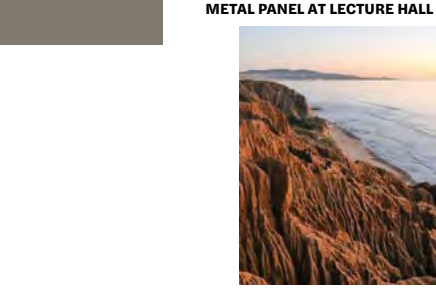
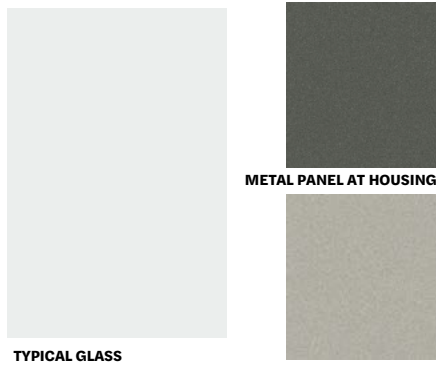
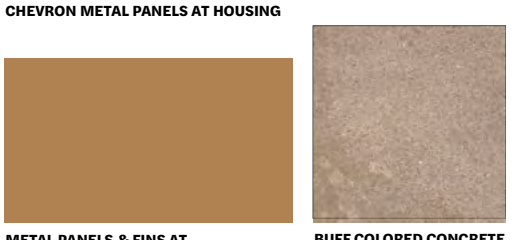
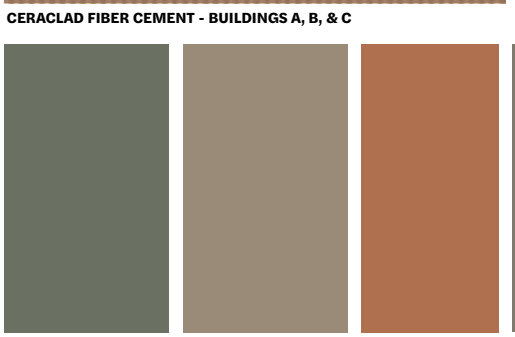
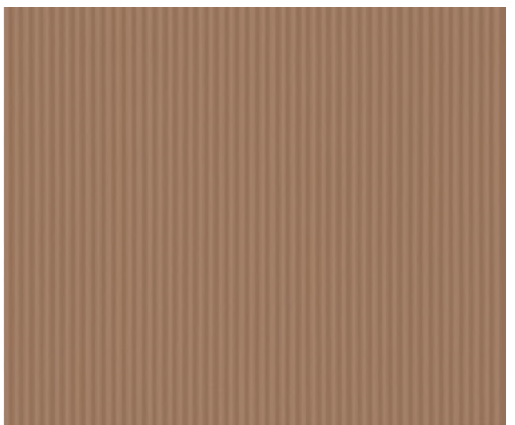
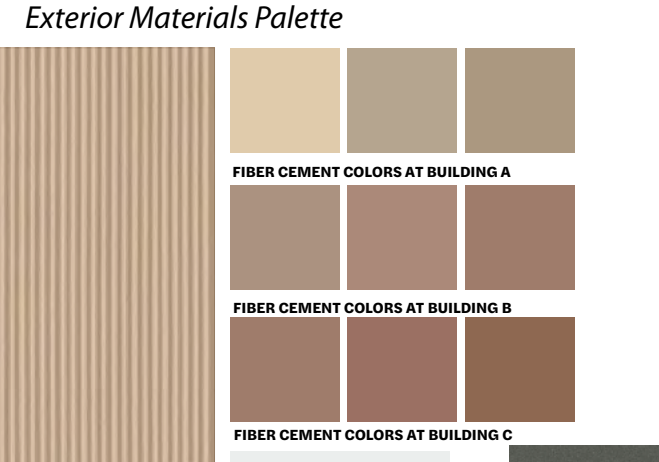
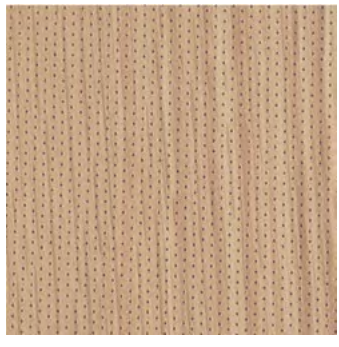
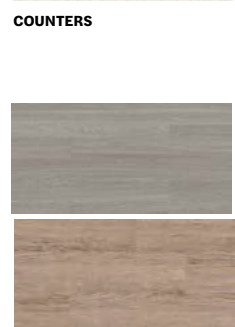
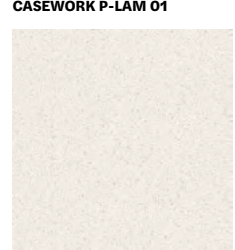
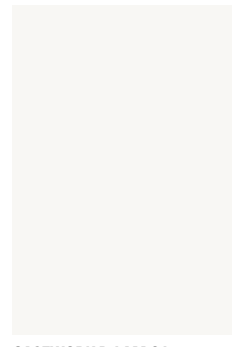
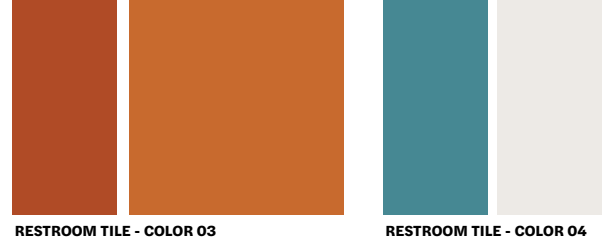



FITNESS TRAIL

Loop providing exercise opportunities



BIO RETENTION BASINS

Storm water system designed to reduce runoff and enhance water retention, filtration and infiltration.



SOLAR READY ROOFTOPS

Rooftops have been designed to accept installation of future solar panel systems



NATURAL VENTILATION

Strategically placed operable windows per facade provide natural ventilation throughout the building



REDUCE SOLAR HEAT GAIN

High Performance Facades that respond to solar orientation, add shading and insulate elevations with high solar exposure



NATURAL LIGHT

Appropriately sized windows with horizontal sun shades that also act as light shelves bring natural light into student housing spaces



TREE CANOPY

Extensive tree planting and replacement helps expand the urban forest and provides benefits including CO₂ sequestration, runoff reduction, reduction of heat island effect and shade for users.



CARBON POSITIVE STRATEGIES

Trees remove carbon from the atmosphere and store it by the process of photosynthesis



RESILIENT ECOLOGIES

Use of local plants that adapt to the local weather and conserve water use



EMBODIED CARBON

Reduce the embedded carbon by using reduced CO₂ concrete from products like Cemex Vertua



INCREASE DENSITY FOR INCREASED OPEN SPACE

Redevelopment of under utilized land to increase density allows for increased open space and green space



SOCIAL JUSTICE AND URBAN LANDSCAPES

Creating an open campus that has a public serving restaurant and amenity spaces while providing equal opportunities for outdoor access