

Office of the President

TO MEMBERS OF THE COMMITTEE ON GROUNDS AND BUILDINGS:

DISCUSSION ITEM

For Meeting of May 10, 2016

PLANS FOR THE GEFFEN ACADEMY, LOS ANGELES CAMPUS

EXECUTIVE SUMMARY

The proposed project would be to renovate the existing 75,000-gross-square-foot Kinross Building to provide a facility for the new Geffen Academy on the Los Angeles campus. The Geffen Academy at UCLA (the Academy) would provide an innovative college preparatory 6th through 12th grade education for up to 620 students by academic year 2020-21. The Academy, to be operated by UCLA, would offer a world-class education to a diverse group of students from across greater Los Angeles and the children of UCLA faculty and staff.

The three-story Kinross Building, located in Lot 36 in the Southwest campus, currently houses campus administrative support functions and a recreation facility that will be relocated prior to the opening of the Academy. Improvements to the Kinross Building site to accommodate the Academy would involve site and interior improvements that would be implemented in phases. The Academy is proposed to open in fall 2017 with 160 students in grades six through nine, and reach full enrollment in 2020-21.

The Academy would help UCLA recruit and retain top faculty whose careers are often influenced by the availability of schools for their children; provide hands-on teaching and educational opportunities for UCLA students who would support Academy faculty; and expand collaborative and educational opportunities for UCLA students, faculty, and families with the campus' existing network of primary and secondary partner schools. Academy students would have access to learning opportunities from existing campus academic programs and cultural resources.

In November 2015, the campus received a \$100 million gift from philanthropist David Geffen to establish the Academy. The donation would fund facility renovations, start-up costs, financial aid, and an endowment. The Geffen Academy would not use any public funds, tuition or fees paid by UCLA students; instead it would be funded by philanthropic gifts and tuition to the Academy.

The campus expects to request budget approval at the Regents' July 2016 meeting. Upon approval of the budget, consideration of design approval and, California Environmental Quality

Act compliance would be eligible for delegation to the Chancellor under the delegated process for capital projects.

BACKGROUND

The proposed Geffen Academy would advance UCLA's mission of research, teaching, and service by providing an innovative college preparatory education for 6th through 12th grade students from the greater Los Angeles area and the children of UCLA faculty and staff. The school is intended to serve a diverse population of students from families of different racial, ethnic, linguistic, religious, and socioeconomic backgrounds. Half of the students would come from UCLA staff and faculty families and the other half from the larger Los Angeles community. The Academy is proposed to open for the 2017-18 school year with approximately 160 students in grades six through nine. Enrollment is projected to increase to 620 students in grades six through 12 by the 2020-21 school year. The Academy would be housed in an existing campus building requiring site and interior improvements to accommodate the program. New faculty and staff would be hired to operate the Academy.

Funding

In November 2015, the campus received a \$100 million gift from philanthropist David Geffen to establish the Academy. The donation would fund facility renovations, faculty and curriculum development, and other key strategic tasks needed to launch the school on the UCLA campus. It would fund a financial aid program for low- and middle-income families, and establish a \$30 million endowment for the new school that would also help to support UCLA's existing network of primary and secondary partner schools.

Project Drivers

Establishing the Academy in the existing Kinross building is supported by the following drivers:

- Community Engagement / Learning Opportunities

Operation of the Academy would provide hands-on teaching and educational opportunities for UCLA graduate and undergraduate students. Academy faculty and staff would participate in the collaboration that already occurs among an existing network of partner schools (including the UCLA Lab School, the UCLA Community School, and four nearby public schools) to expand educational opportunities for students, faculty, and families. It would also strengthen the role of the Graduate School of Education and Information Studies, the UCLA School that serves as the conduit for the sharing of ideas, teaching methodologies, and educational data among UCLA and the partner schools.

- Faculty Recruitment

The Academy would help UCLA recruit and retain top faculty whose career decisions are often influenced by availability of high quality college preparatory education for their

children. Affordable, socially diverse, and academically rigorous programs are needed close to where they work. UCLA currently operates pre-school and elementary school programs for children of faculty and staff on the Westwood campus, but lacks a program for secondary education. Establishment of a college preparatory program would allow UCLA to bridge this program gap by offering an innovative educational environment for middle and high school-aged children with access to the academic and cultural resources of the University.

Kinross Building

The Kinross Building, located in the Southwest campus, has been identified as the preferred site for the proposed Geffen Academy. The building currently houses administrative office space supporting the research program at UCLA, the Office of Intellectual Property, a conservation laboratory for the campus library, collection storage for the Fowler Museum, and a recreation facility used by graduate students, faculty, and staff. These occupants and programs would be relocated to other existing campus facilities that is either ready for occupancy or can be made appropriate for specific use with minor repair. The three-story building, originally constructed as a staging facility for occupants of structurally deficient buildings, has accommodated a variety of functions including classrooms; art, dance and exercise studios; and gallery space, shops, and offices. The building is readily accessible by both private and public transportation, and its perimeter can be secured for use as a school.

PROJECT DESCRIPTION

The 75,000-gross-square-foot Kinross Building would be renovated to accommodate the proposed Geffen Academy. The renovated building would include classrooms, an assembly space, office space for faculty and administrators, indoor athletic space, and building support space. An existing exterior area on the east side of the building would be utilized for outdoor arts programs.

Interior renovation work would involve reconfiguration of non-load bearing walls; replacement of lighting, finishes, and fixtures; and upgrades to building systems to accommodate the program. Site work would include: reorientation of the main entrance from the north side of the building to the west side; creation of a vehicular circulation route for queueing and pick-up/drop-off locations adjacent to the building; and installation of fencing to secure the site for use as a school. Landscaping, lighting, and related site improvements would be provided. Implementation would be performed in phases corresponding to the four-year occupancy plan.

Project space components are described below:

Teaching Space: Teaching space would include general purpose classrooms, as well as rooms equipped for instruction in science, fine arts, performing arts, dance, and digital media.

Assembly Space: A multi-purpose space would accommodate a variety of functions at different times of the day, including as a general assembly venue, theater, and dining hall. Support space

would include a catering kitchen for assembly of food items prepared at other locations, and storage for furniture and audio visual equipment.

Athletic Space: Indoor athletic space would accommodate instruction and practice for such activities as dance, wrestling, yoga, and cardio/resistance training. Basketball and volleyball practice and instruction would be accommodated in an outdoor recreation area.

Offices: Open workstation space would be provided for faculty, teaching assistants, readers, and administrative staff. Conference rooms of various sizes would be provided for confidential meetings, private phone conversations, and general administrative use.

Building Support: Building support space would include a main lobby, student lockers, and network server rooms.

Proposed Site

The Kinross Building is located on a two-acre site at the northeast corner of Lot 36 in the Southwest campus (Attachment 1). The site is bordered by Kinross Avenue and Parking Structure 32 to the north, a public alley (Midvale Alley) and Westwood Village to the east, the Kinross South Building to the south, and Parking Lot 36 to the west. Various transit uses serve the project site including city bus lines along Kinross Avenue and nearby Wilshire Boulevard, campus express buses at Lot 36, and an airport shuttle on the north of Kinross adjacent to Parking Structure 32.

Vehicles would enter the site along Midvale Alley, proceed to a pick-up/drop-off location on the west side of the building, and exit the site onto Kinross Avenue. Onsite vehicle queueing areas, a new driveway from the site to Kinross Avenue, and modifications to an adjacent bus stop would be constructed as part of the project. Parking would be provided onsite, adjacent to Lot 36, for faculty and staff, and visitor/short-term parking for parents.

Key to Acronyms

CEQA	California Environmental Quality Act
------	--------------------------------------

ATTACHMENTS:

- Attachment 1: Location
- Attachment 2: Site Plan
- Attachment 3: Alternatives Considered

SITE LOCATION

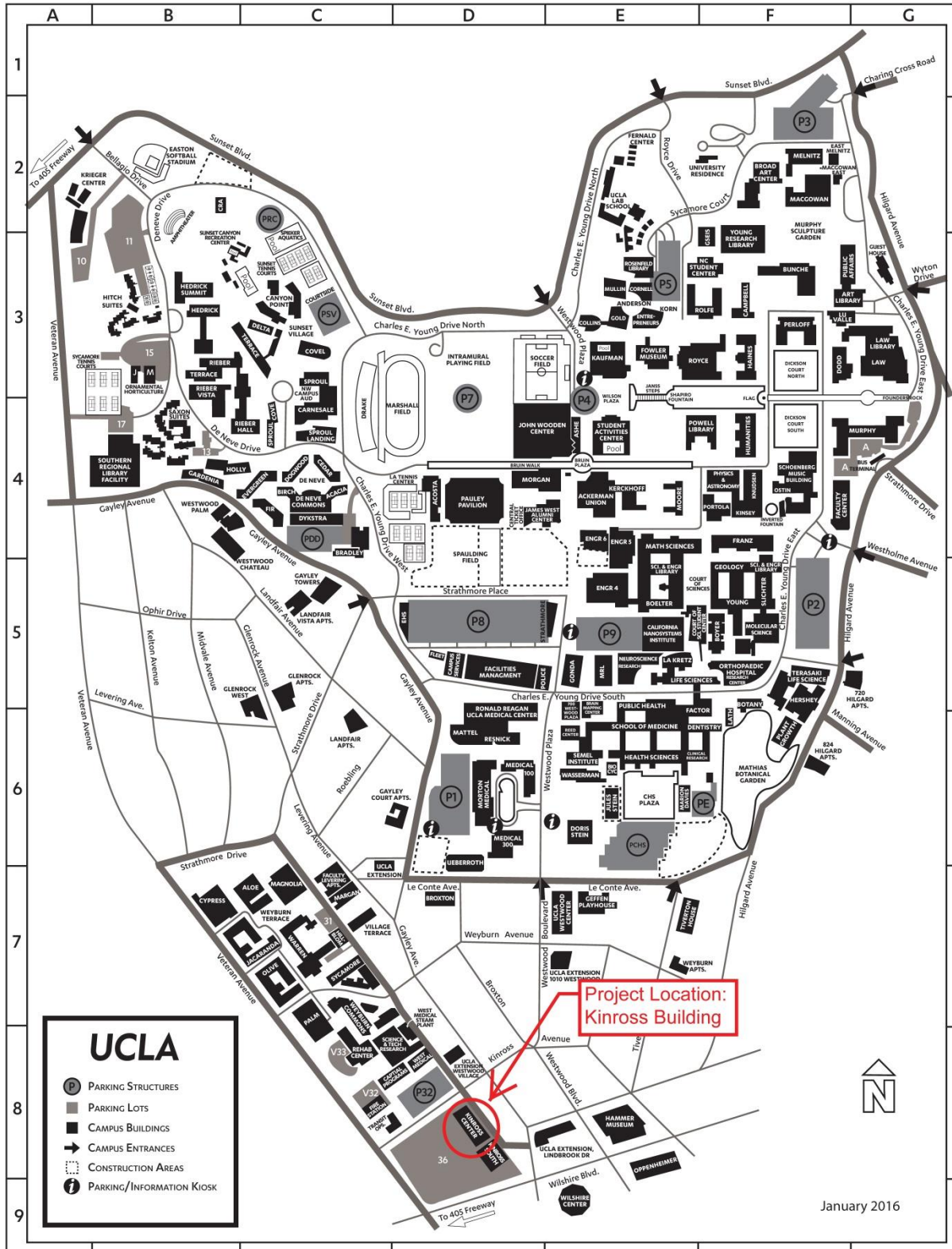

SITE PLAN

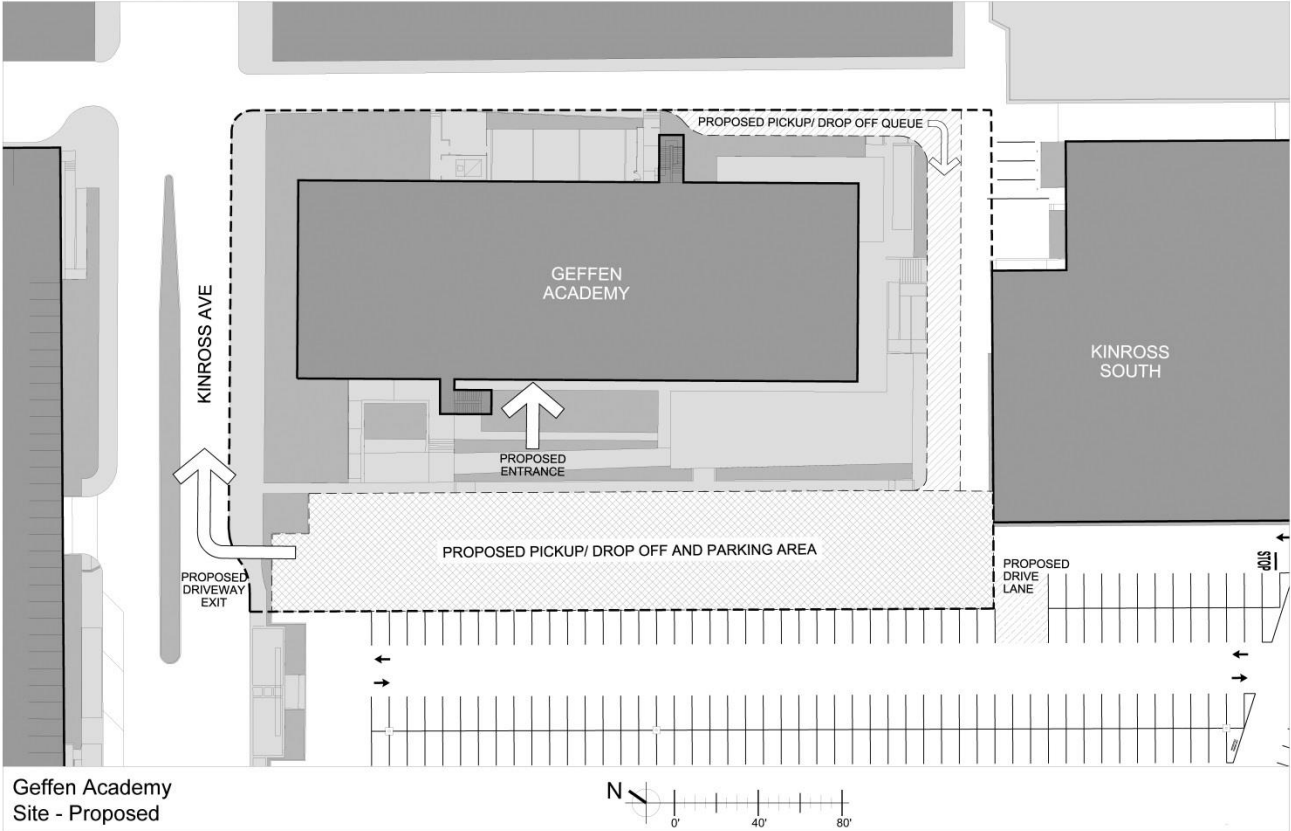

ALTERNATIVES CONSIDERED

The following alternatives were considered as part of the Business Case Analysis for this project:

- 1) No Project: This alternative would not provide a facility to create an Academy. The gap in UCLA educational programs between serving elementary grades through existing programs and middle- to high-school-aged children through the Academy would remain. UCLA and community families would not benefit from attendance at an innovative school leveraging University academic and cultural resources.
- 2) Off-Campus: This alternative would locate the Academy at one of UCLA's existing partner schools or at another public school site in West Los Angeles. This alternative was not considered feasible because of a lack of an available site that could accommodate both the Academy and existing school programs at the same location. In addition, an off-campus location was not considered to be desirable for an educational program dependent on access to resources on the UCLA campus.
- 3) On-Campus – Kinross Building: This alternative would locate the Academy in the Kinross Building on the Southwest campus. This facility, proximate to public transportation and campus express buses, would provide students with convenient access to on-campus resources. It was originally built to accommodate many of the programmatic spaces needed by the Academy, and the site around the building can be secured for use as a middle- and high-school facility. To accommodate the proposed program, the functions that currently occupy the building will be relocated to other University facilities.